

WELD FITTINGS



**Highland
Equipment Inc.**

Stainless Steel Equipment

L9WWW7

Cross - Weld Style

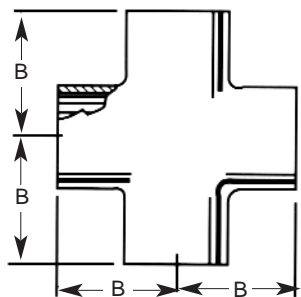

Mat'l Available

304/316L
304/316L
304/316L
304/316L
304/316L
304/316L
304/316L

Size/Tube OD	B
1"	1.87500
1-1/2"	2.25000
2"	3.00000
2-1/2"	3.00000
3"	3.25000
4"	3.87500
6"	5.00000

Weld reducing cross available upon request.

L2S7

Elbow -Weld Standard 90'

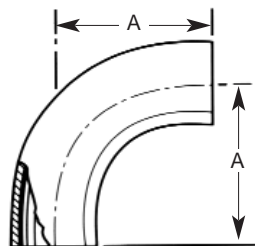

Mat'l Available

316L
316L
304/316L
304/316L
304/316L
304/316L
304/316L
304/316L

Size/Tube OD	A
1/2"	3.00000
3/4"	3.00000
1"	2.06250
1-1/2"	2.93750
2"	4.06250
2-1/2"	5.18750
3"	6.31250
4"	8.31250

L2KS7

Elbow -Weld Standard 45'

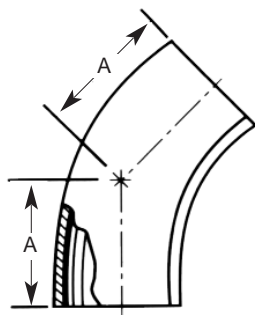

Mat'l Available

316L
316L
304/316L
304/316L
304/316L
304/316L
304/316L
304/316L

Size/Tube OD	A
1/2"	2.25000
3/4"	2.25000
1"	1.18750
1-1/2"	1.62500
2"	2.31250
2-1/2"	3.00000
3"	3.68750
4"	4.81250

WELD FITTINGS



**Highland
Equipment Inc.**

Stainless Steel Equipment

2WCL

Elbow - 90 Degrees

This Item available in #7 Standard ID/OD

Polish or #1 Tumble Finish ID/OD

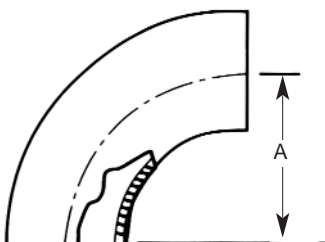

Mat'l Available

316L
316L
304/316L
304/316L
304/316L
304/316L
304/316L
304/316L
304/316L

Size/Tube OD	A
1/2"	1.25000
3/4"	1.12500
1"	1.50000
1-1/2"	2.25000
2"	3.00000
2-1/2"	3.75000
3"	4.50000
4"	6.00000
6"	9.00000

2WK7

Elbow - Weld Short 45'

This Item available in #7 Standard ID/OD

Polish or #1 Tumble Finish ID/OD

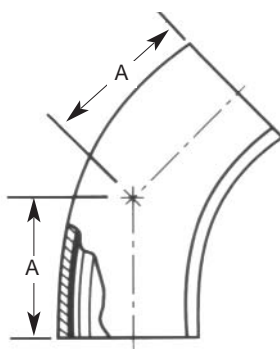

Mat'l Available

316L
316L
304/316L
304/316L
304/316L
304/316L
304/316L
304/316L
304/316L

Size/Tube OD	A
1/2"	0.51800
3/4"	0.46600
1"	0.62500
1-1/2"	0.93750
2"	1.25000
2-1/2"	1.56250
3"	1.87500
4"	2.50000
6"	3.75000

2SXL7

Elbow-Weld Sweep/Long Radius

90 Degree

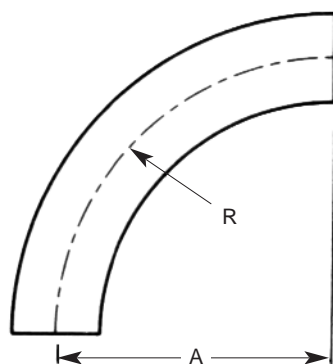

Mat'l Available

316L
316L
316L
316L
316L
316L
316L
316L
316L
316L
316L
316L
316L
316L
316L

Radius	A	R
1-1/2"	12.00000	12.00000
2"	12.00000	12.00000
2"	18.00000	18.00000
2"	24.00000	24.00000
2-1/2"	18.00000	18.00000
2-1/2"	24.00000	24.00000
3"	12.00000	12.00000
3"	18.00000	18.00000
3"	24.00000	24.00000
3"	36.00000	36.00000
4"	18.00000	18.00000
4"	24.00000	24.00000
4"	36.00000	36.00000

Weld 45' sweep elbows available upon request.

Clamp 45 degree and 90 degree elbows, available upon request.

WELD FITTINGS



**Highland
Equipment Inc.**

Stainless Steel Equipment

L2CM7
Elbow - Weld x Clamp
Standard 90'

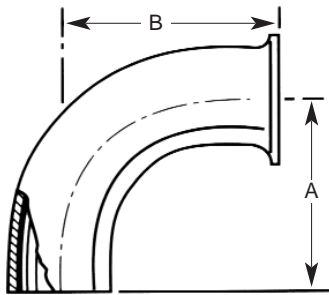

Mat'l Available

304/316L
304/316L
304/316L
304/316L
304/316L
304/316L

Size/Tube OD	A	B
1"	2.06250	2.56250
1-1/2"	2.93750	3.43750
2"	4.06250	4.56250
2-1/2"	5.18750	5.68750
3"	6.31250	6.81250
4"	8.31250	8.93750

L2KM7
Elbow - Weld x Clamp
Standard 45'

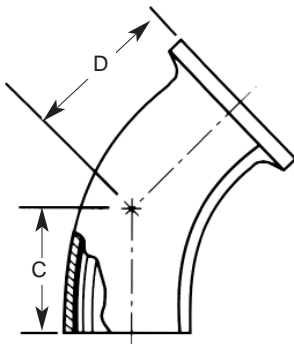

Mat'l Available

304/316L
304/316L
304/316L
304/316L
304/316L
304/316L

Size/Tube OD	C	D
1"	1.18750	1.68750
1-1/2"	1.62500	2.12500
2"	2.31250	2.81250
2-1/2"	3.00000	3.50000
3"	3.68750	4.18750
4"	4.81250	4.43750

WELD FITTINGS



**Highland
Equipment Inc.**

Stainless Steel Equipment

L317
Reducer - Weld Concentric

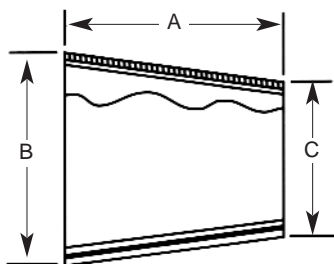

Mat'l Available

316L

316L

316L

316L

304/316L

304/316L

304/316L

304/316L

304/316L

304/316L

304/316L

304/316L

304/316L

304/316L

304/316L

304/316L

304/316L

304/316L

304/316L

304/316L

304/316L

304/316L

304/316L

304/316L

304/316L

Size/Tube OD	A	B	C
1-1/2" x 1/2"	4.00000	1.50000	0.50000
1-1/2" x 3/4"	3.00000	1.50000	0.75000
1" x 1/2"	2.00000	1.00000	0.50000
1" x 3/4"	1.00000	1.00000	0.75000
1-1/2" x 1"	2.00000	5.50000	1.00000
2" x 1"	4.00000	2.00000	1.00000
2" x 1-1/2"	2.00000	2.00000	1.50000
2-1/2" x 1"	6.00000	2.50000	1.00000
2-1/2" x 1-1/2"	4.00000	2.50000	1.50000
2-1/2" x 2"	2.00000	2.50000	2.00000
3" x 1"	8.00000	3.00000	1.00000
3" x 1-1/2"	6.00000	3.00000	1.50000
3" x 2"	4.00000	3.00000	2.00000
3" x 2-1/2"	2.00000	3.00000	2.50000
4" x 1"	12.00000	4.00000	1.00000
4" x 1-1/2"	10.00000	4.00000	1.50000
4" x 2"	8.00000	4.00000	2.00000
4" x 2-1/2"	6.00000	4.00000	2.50000
4" x 3"	4.00000	4.00000	3.00000
6" x 1"	14.00000	6.00000	1.00000
6" x 1-1/2"	12.00000	6.00000	1.50000
6" x 2"	10.00000	6.00000	2.00000
6" x 2-1/2"	8.00000	6.00000	2.50000
6" x 3"	6.00000	6.00000	3.00000
6" x 4"	4.00000	6.00000	4.00000

WELD FITTINGS



**Highland
Equipment Inc.**

Stainless Steel Equipment

L31M7

Reducer- Concentric, Weld x Clamp

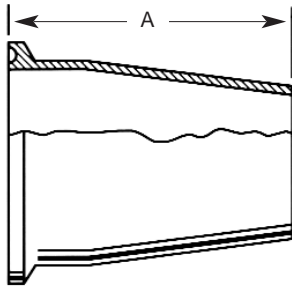

Mat'l Available

304/316L
304/316L
304/316L
304/316L
304/316L
304/316L
304/316L
304/316L
304/316L
304/316L
304/316L
304/316L
304/316L
304/316L
304/316L
304/316L
304/316L

Size/Tube OD	A
1-1/2" x 1"	2.50000
2" x 1"	4.50000
2" x 1-1/2"	2.50000
2-1/2" x 1"	6.50000
2-1/2" x 1-1/2"	4.50000
2-1/2" x 2"	2.50000
3" x 1"	8.50000
3" x 1-1/2"	6.50000
3" x 2"	5.00000
3" x 2-1/2"	2.50000
4" x 1"	12.6250
4 x 1-1/2"	10.6250
4" x 2"	8.6250
4" x 2-1/2"	6.625
4" x 3"	4.625

L32M7

Reducer- Eccentric, Weld x Clamp

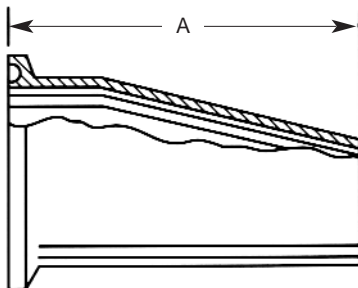

Mat'l Available

304/316L
304/316L
304/316L
304/316L
304/316L
304/316L
304/316L
304/316L
304/316L
304/316L
304/316L
304/316L
304/316L
304/316L
304/316L
304/316L
304/316L
304/316L

Size/Tube OD	A
1-1/2" x 1"	2.50000
2" x 1"	4.50000
2" x 1-1/2"	2.50000
2-1/2" x 1"	6.50000
2-1/2" x 1-1/2"	4.50000
2-1/2" x 2"	2.50000
3" x 1"	8.50000
3" x 1-1/2"	6.50000
3" x 2"	5.00000
3" x 2-1/2"	2.50000
4" x 1"	12.6250
4 x 1-1/2"	10.6250
4" x 2"	8.6250
4" x 2-1/2"	6.625
4" x 3"	4.625

WELD FITTINGS



**Highland
Equipment Inc.**

Stainless Steel Equipment

L7WWW7
Tee- Weld Short

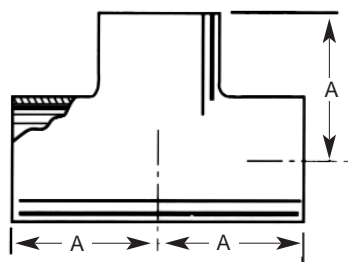

Mat'l Available

304/316L
304/316L
304/316L
304/316L
304/316L
304/316L

Size/Tube OD	A
1"	1.12500
1-1/2"	1.65600
2"	2.06200
2-1/2"	2.34400
3"	2.59400
4"	3.43800

L7W7
Tee- Weld Long

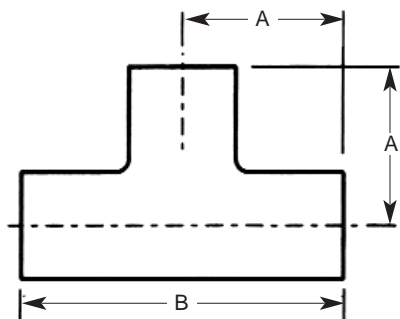

Mat'l Available

316L
316L
304/316L
304/316L
304/316L
304/316L
304/316L
304/316L
304/316L
304/316L
304/316L

Size/Tube OD	A	B
1/2"	1.87500	3.75000
3/4"	2.00000	4.00000
1"	1.18750	3.75000
1-1/2"	2.25000	4.50000
2"	3.00000	6.00000
2-1/2"	3.00000	6.00000
3"	3.25000	6.50000
4"	3.87500	7.75000
6"	5.62500	11.25000
8"	7.00000	14.00000
10"	8.50000	17.00000
12"	10.00000	20.00000

WELD FITTINGS



**Highland
Equipment Inc.**

Stainless Steel Equipment

L7RWWW7
Tee - Reducing

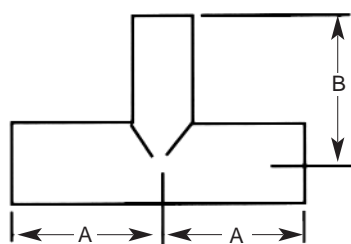

Mat'l Available

	Size/Tube OD	A	B
316L	1-1/2" x 1/2"	2.38000	2.38000
316L	1-1/2" x 3/4"	2.38000	2.38000
316L	1" x 1/2"	2.13000	2.13000
316L	1" x 3/4"	2.13000	2.13000
304/316L	1-1/2" x 1"	1.65600	1.37500
304/316L	2" x 1"	2.06200	1.62500
304/316L	2" x 1-1/2"	2.06200	1.90600
304/316L	2-1/2" x 1"	2.33400	2.15600
304/316L	2-1/2" x 1-1/2"	2.34400	2.15600
304/316L	2-1/2" x 2"	2.34400	2.31200
304/316L	3" x 1"	2.59400	2.40600
304/316L	3" x 1-1/2"	2.59400	2.40600
304/316L	3" x 2"	2.59400	2.56100
304/316L	3" x 2-1/2"	2.59400	2.59400
304/316L	4" x 1"	3.43800	2.90600
304/316L	4" x 1-1/2"	3.43800	2.90600
304/316L	4" x 2"	3.43800	3.06200
304/316L	4" x 2-1/2"	3.43800	3.09400
304/316L	4" x 3"	3.43800	3.15600
304/316L	6" x 3"	5.62500	4.87500
304/316L	6" x 4"	5.62500	5.12500

L7WWM
Tee - Weld x Clamp

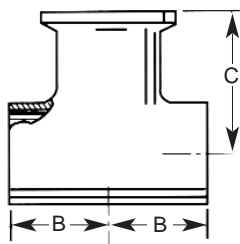

Mat'l Available

	Size/Tube OD	B	C
304/316L	1"	1.62500	1.12500
304/316L	1-1/2"	1.65625	2.15625
304/316L	2"	2.06250	2.56250
304/316L	2-1/2"	2.34375	2.84375
304/316L	3"	2.59375	3.09375
304/316L	4"	3.43750	4.06250

WELD FITTINGS



Highland
Equipment Inc.
Stainless Steel Equipment

136 The East Mall
Toronto, Ontario
M8Z 5V5

Tele: 416 236-9610
Fax: 416 236-9611
Toll Free: 800-956-5630

2WUL7
U-Bend - Weld

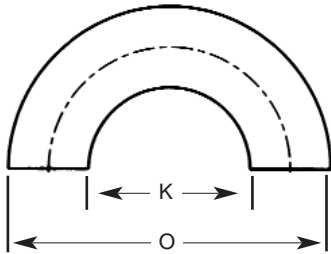

Mat'l Available

- 316L
- 316L
- 316L
- 316L
- 316L

Size/Tube OD	T	K	O
1"	0.07000	2.00000	3.05000
1-1/2"	0.07000	3.05000	4.57000
2"	0.07000	4.06000	6.10000
2-1/2"	0.07000	5.08000	7.62000
3"	0.07000	6.10000	9.14000
4"	0.08000	8.13000	12.19000

Available in #7 ID/OD polish and tumble finish.
Clamp style also available upon request.

T= Thickness

L28A-7
"Y" - Lateral Y Weld Style

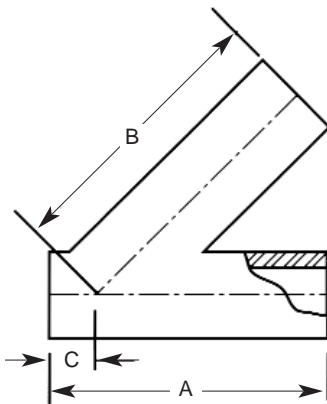

Mat'l Available

- 316L
- 316L
- 304/316L
- 304/316L
- 304/316L
- 304/316L
- 304/316L
- 304/316L
- 304/316L

Size/Tube OD	A	B	C
1/2"	6.00000	5.00000	1.00000
3/4"	6.00000	5.00000	1.00000
1"	6.00000	5.00000	1.00000
1-1/2"	7.37500	6.18750	1.18750
2"	8.75000	7.12500	1.62500
2-1/2"	10.00000	8.50000	1.50000
3"	10.75000	8.87500	1.87500
4"	12.81250	10.75000	2.06250
6"	16.50000	12.50000	4.00000

Reducing weld lateral Y also available upon request.

L28B-7
"Y" - True Y Weld Style

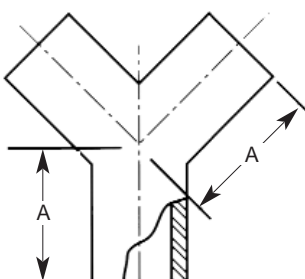

Mat'l Available

- 316L
- 316L
- 304/316L
- 304/316L
- 304/316L
- 304/316L
- 304/316L
- 304/316L
- 304/316L
- 304/316L

Size/Tube OD	A
1/2"	2.00000
3/4"	2.00000
1"	3.00000
1-1/2"	3.00000
2"	4.00000
2-1/2"	5.00000
3"	6.00000
4"	8.00000
6"	8.00000